

# EURO 2012 FUßBALLSTADION

Breslau, Polen, 2007 Wettbewerb - Ankauf

In response to the urban renewal around the Euro 2012 venue, the site is bordered by an idyllic natural area with moving water courses and plants to the east; in the west it meets an elevated straight section of a new town motorway. The site is thus a striking point of urban infrastructure.

Copper is the traditional mineral resource of the region. A network of encompassing horizontal copper strips form the primary weather protection for the stadium. At night the lit stadium forms a dialogue with the motorway.

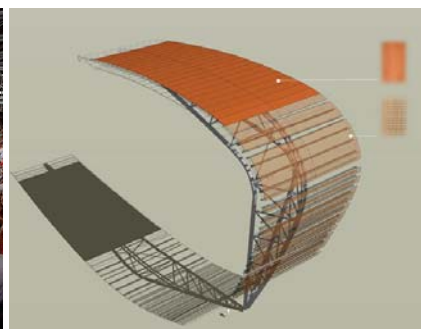

**WIRTH+WIRTH** ARCHITEKTEN

Leimenstrasse 47, 4002 Basel, Switzerland  
Tel. +41 61 270 12 12 Fax +41 61 270 12 10  
wirth.basel@wirth-wirth.ch www.wirth-wirth.ch

**Projekt:** 2007

**Location:** Breslau, Polen

**Nutzungsart:** Stadion, Sport-Campus, 45'000 Sitzplätze  
VIP, Büros, Einzelhandel, Parken

**Aufgabe:** Gelandener Wettbewerb - Ankauf

**Fläche:** ca 64'000 m<sup>2</sup>

**Bauherrschaft:** Breslau Stadt